



Teleterm RPN Configurator

Model C5140A Teleterm Fibre Optic Radiation Protection Gateway Configurator

DATASHEET

- Enables portable configuration of one Teleterm Radiation Protection Gateway (RPN1) via a PC.
- Provides RJ45 to fibre optic conversion.
- Supplies AC power to one Teleterm Radiation Protection Gateway (RPN1).



Features

- Portable configuration of RPN
- AC Powered

Overview

The Omniflex Teleterm RPN configurator simplifies the process of configuring the Radiological Protection Gateway (RPN1).

It provides an interface for an engineer to directly connect a computer running the Omniset Pro configuration software to a Radiological Protection Gateway (RPN1).

Simply power the RPN1 configurator with an IEC power cord, connect a computer using an ethernet cable to the RJ45 connector and connect the RPN1 using a Power+Fibre Link cable.

The RPN Configurator will power the RPN1 unit and it will provide a communication link between the RPN 1 unit and the configuration software on the computer.

Connection Diagram

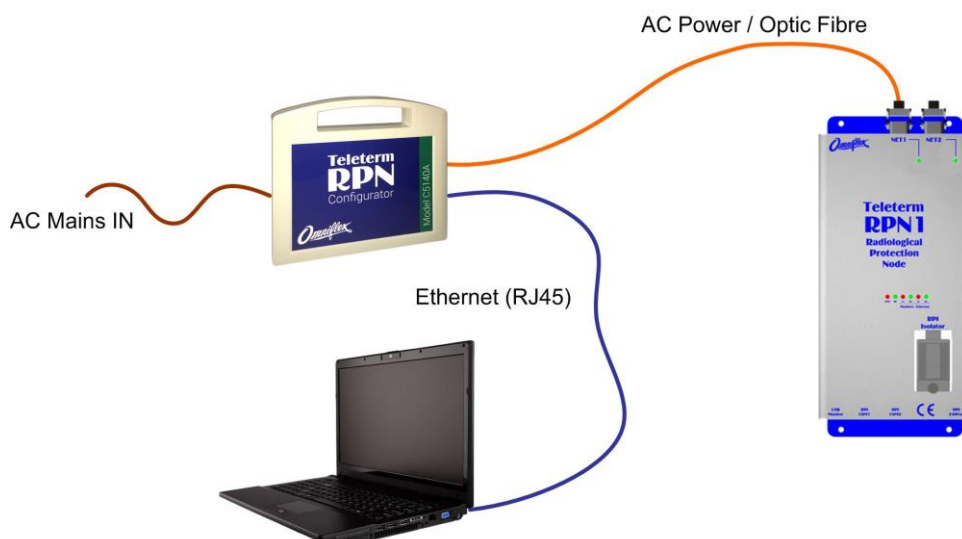



Teleterm RPN Configurator

Model C5140A Teleterm Fibre Optic Radiation Protection Gateway Configurator

Mechanical Details

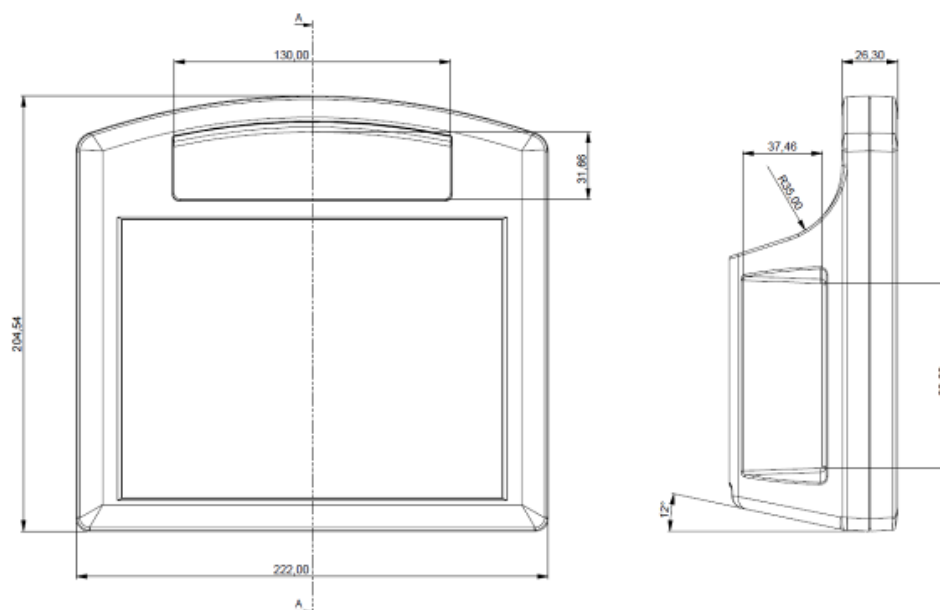

Specifications

Ethernet Network Ports

Fibre Optic Ethernet Port	802.3u 100BaseFX
Optical Fibre	1300nm multimode
RJ45 Ethernet Port	802.3u 10/100BaseFX

Power Requirements

AC Input Voltage	85-264 Vac
Power Cable	C6 IEC Connector
AC Input Frequency	47-63Hz
Input current	<0.55A rms at 115Vac <0.35A rms at 230Vac (excludes current to Radiation Monitor)
Switch-on inrush current	20A at 115Vac 40A at 230Vac

LED Indicator

On side of the unit (near mains connector)

Power	Green	ON = Mains Connected and 24V ON. OFF = 24V OFF.
-------	-------	----------------------------------------------------

Environment

Operating Temperature	0 to +60°C (+32°F – 140°F)
Storage Temperature	-10°C – 70 °C (+14°F – 158°F)

Mechanical

Width	222mm
Height	203mm
Depth	80mm

Weight

Unpacked	300gm approx.
Packed	400gm approx.

Compliance to Standards

Safety	UL 508
Emissions	EN 55011 and EN50081-2:1994 Group I, Class A
Immunity – ESD	IEC 61000-4-2:2001, level 3
Immunity – RF Fields	IEC 61000-4-3:2003, level 3
Immunity – Fast Transients	IEC 61000-4-4:2004 2 kV – AC power ports 1 kV – other input/output lines
Insulation Resistance (100% tested)	100Mohm at 500Vdc input to outputs to ground.

Ordering Information

ORDER CODE	DESCRIPTION
C5140A	Teleterm RPN Configurator
C1210A-xx	Power+Fibre link cable (xx = length in m)

